

Poszerzyliśmy ofertę o następujące produkty naszej marki:

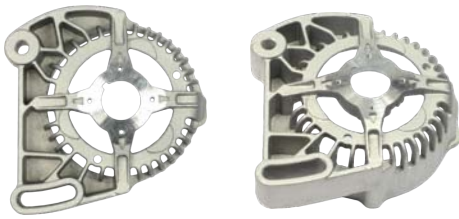

ABR4046

Cross: Magneti Marelli
Cargo 230223, Woodauto BKT4020
old type CA890IR
In offer also: ABR4001



ARC0138

Cross: Hitachi
B+ M6, B+thread 50.4, O.D. 114, Diode Amp. 35,
Diodes 6
For: Bosch 0120488311, 0120488312, 0120488313
WITH TRIO



ARC0139

Cross: Bosch
B+ M6, B+thread 52.5, O.D. 114, Diode Amp. 35,
Diodes 6
For: Bosch 9120061105

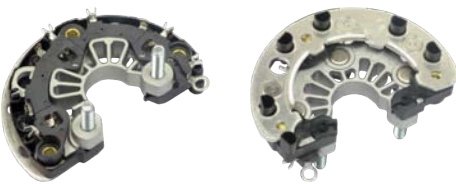

ARC0141

Cross: Bosch
B+ M8, O.D. 129, Diode Amp. 50, Diodes 6



ARC0144

Cross: Bosch
B+ M8, O.D. 129, Diode Amp. 60, Diodes 6
With Negative heat sink



ARC0145

Cross: Bosch
B+ M8, O.D. 120, Diode Amp. 50, Diodes 6



ARC0146

Cross: Bosch
B+ M8, B+thread 30, O.D. 122, Diode Amp. 50, Diodes 14
WITH TRIO



ARC4035

Cross: Magneti Marelli
B+ M6, B+thread 43.7, O.D. 120, Diode Amp. 35,
Diodes 6
WITH TRIO



ARC4036

Cross: Magneti Marelli
B+ M6, B+thread 39.5, O.D. 111, Diode Amp. 50,
Diodes 6

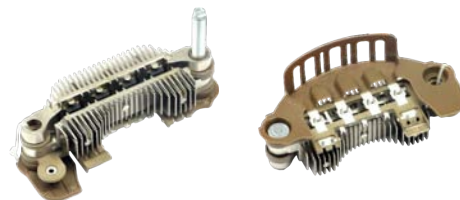

ARC5128

Cross: Mitsubishi
For: Mitsubishi A4TA8494



ARC5129

Cross: Mitsubishi
B+ M8, B+thread 59.5, Mounting dist. 100, Diode Amp. 35,
Diodes 8
WITH TRIO



ARC5131

Cross: Mitsubishi
B+ M8, B+thread 59.5, O.D. 100, Diode Amp. 30,
Diodes 6
WITH TRIO
WITHOUT CAPACITOR



ARC5132

Cross: Mitsubishi
B+ M6, B+thread 49.5, O.D. 100, Diode Amp. 30,
Diodes 8
WITH TRIO / CAPACITOR

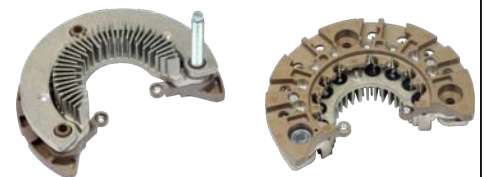

ARC5134

Cross: Mitsubishi
B+ M8, B+thread 59.5, O.D. 128, Diode Amp. 35,
Diodes 16



ARC5136

Cross: Mitsubishi
B+ M5, B+thread 41, Mounting dist. 75, Diode Amp. 30,
Diodes 6
WITHOUT TRIO

Zapraszamy do korzystania z e-sklepu www.as-pl.com

Poszerzyliśmy ofertę o następujące produkty naszej marki:



ARC5137

Cross: Mitsubishi
B+ M6, B+thread 49.5, Mounting dist. 75, Diode Amp. 30, Diodes 6
WITH TRIO / CAPACITOR



ARC5138

Cross: Mitsubishi
Mounting dist. 76, Diode Amp. 30, Diodes 8
WITH TRIO



ARC5139

Cross: Mitsubishi
B+ M5, B+thread 49, Mounting dist. 76, Diode Amp. 30, Diodes 8
WITH TRIO



ARC5141

Cross: Mitsubishi
B+ M5, B+thread 44, Mounting dist. 85, Diode Amp. 6, Diodes 30
WITH TRIO / CAPACITOR



ARC5145

Cross: Mitsubishi
B+ M5, B+thread 44, Mounting dist. 85, Diode Amp. 30, Diodes 8



ARC9037

B+ M5, B+thread 30, Diode Amp. 35, Diodes 6
WITHOUT TRIO
WITHOUT CAPACITOR



ARE0113

Cross: Bosch
Voltage 12
A-Circuit



ARE3082

Cross: Valeo 2542765
Transpo M524, Mobiletron VR-PR2765
Voltage 12
For: Valeo SG10S036, SG10S034, 2650135A, SG12S070, 2542454A, SG12S083, SG12B0S41, SG10S044, SG12S057, SG12S084, **Delco** 226830702 ...
B-Circuit
Soft Start 30 %
LRC 5 sec
Field Shorted Circuit Protection
Sense Open Indication
Under Voltage Indication
Over Voltage Indication
DFM function
Self exciting function



ARR2039

Cross: Hitachi
Voltage 12



ARR9001

Cross: Hyundai / Kia
Voltage 12

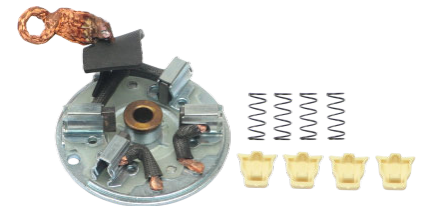

SBH9011

Cross: Hyundai / Kia
For: Hyundai / Kia 361002A300



SBR1001

Cross: Delco
For: Delco 19011501



SD0220

Cross: Bosch 1006209819
Vw 046911342BB, 059911335E
No./teeth 9, **No./splines** 16, **Lenght** 83.2, **O.D.** 27.5, **Shaft** 12, **Rotation** CW
For: Bosch 0001125521, 0001125519



SD3053

Cross: Valeo 594034, 184795
Cargo 139318, **Woodauto** SDV37612
No./teeth 9, **No./splines** 9, **Lenght** 66.5, **O.D.** 29.6, **Shaft** 12, **Rotation** ACW
For: Valeo D6RA60, D6RA54, D6RA17, D6RA27, D6RA19, D6RA34, D6RA29, D6RA50

Znajdź nas na [facebook.com/asplcom](https://www.facebook.com/asplcom)